

# STEEL FRAMING

Solutions for designing and building in lightweight steel frame



**rothoblaas**

Solutions for Building Technology



# RESIDENTIAL, COMMERCIAL AND INDUSTRIAL BUILDINGS

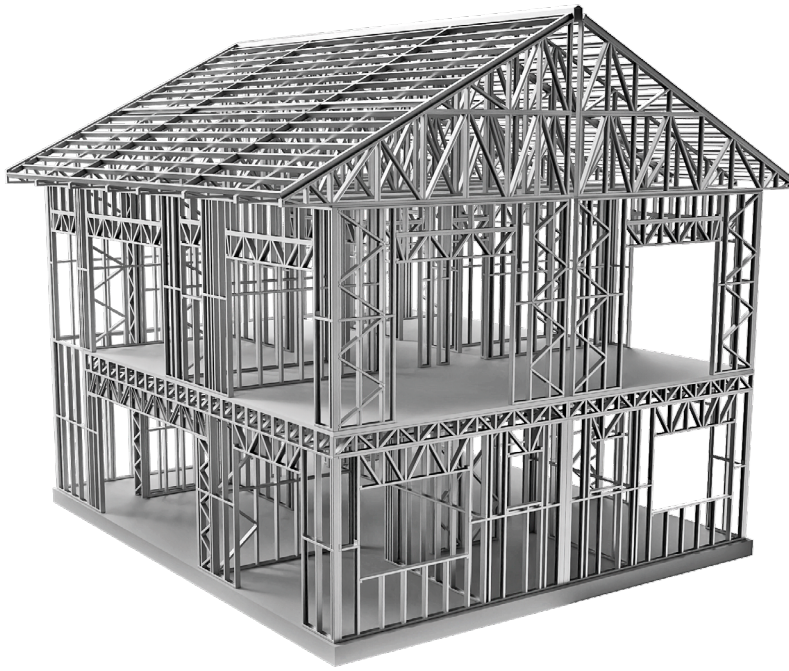

Lightweight Steel Frame technology uses thin steel profiles made by the cold-forming process. This technology dates back to the mid-1800s. There has been a surge in technological innovation and commercial deployment since the early 1980s.

Lightweight, quick execution, optimization of the construction cycle and recycling of raw materials are driving the growing success of this construction system.

In order to take advantage of these benefits and ensure energy-efficient buildings, however, it is essential to insulate the building, minimize thermal bridges, and ensure effective air and wind sealing.

The choice of membranes to be placed inside the building casing is highly dependent on climatic conditions. For example, the vapor flow in a stratigraphy placed in a tropical or torrid climate is opposite to the vapor flow in an arctic or cold climate.

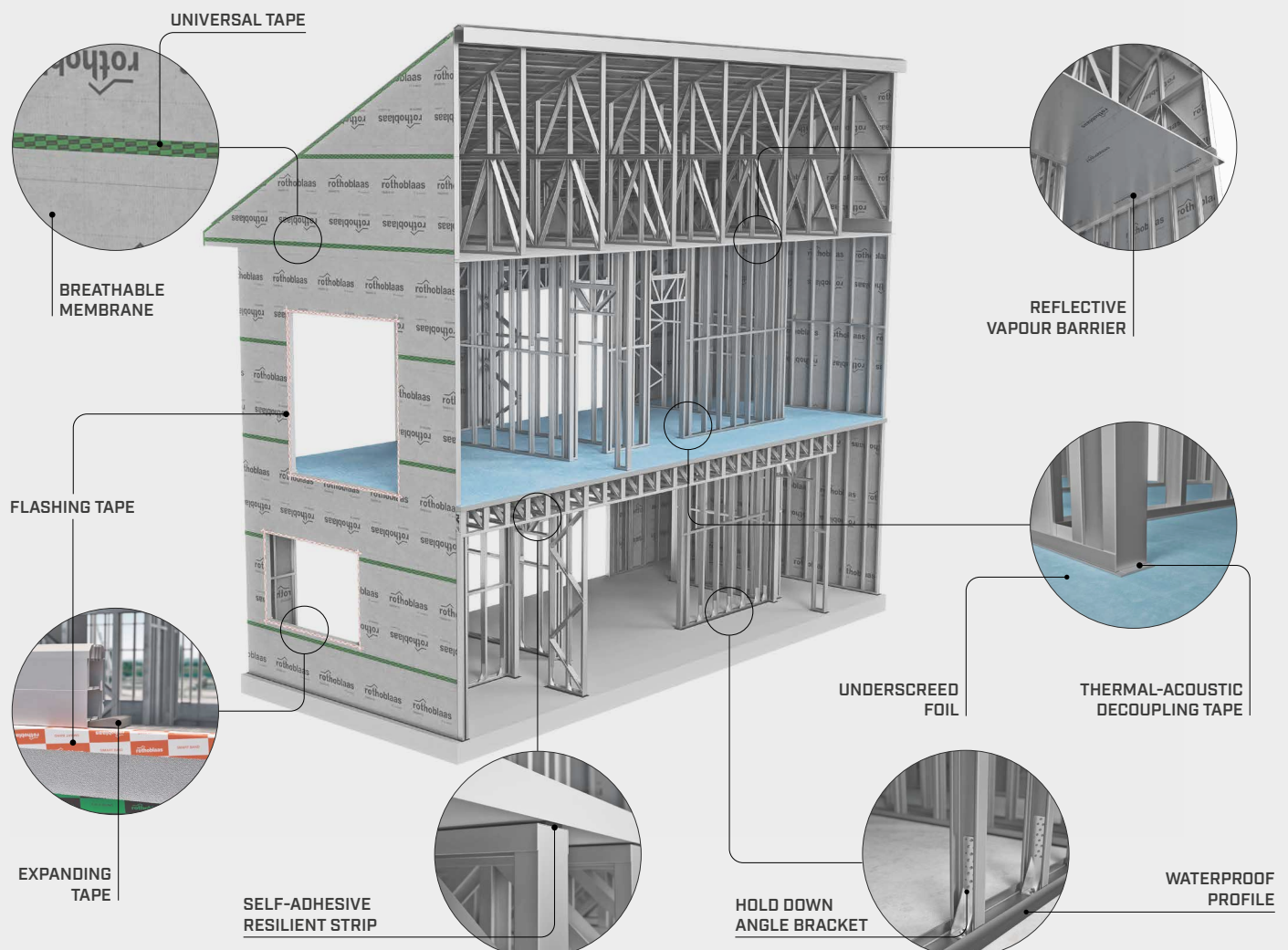

# FAÇADES, OVERCLADDING, RECLADDING

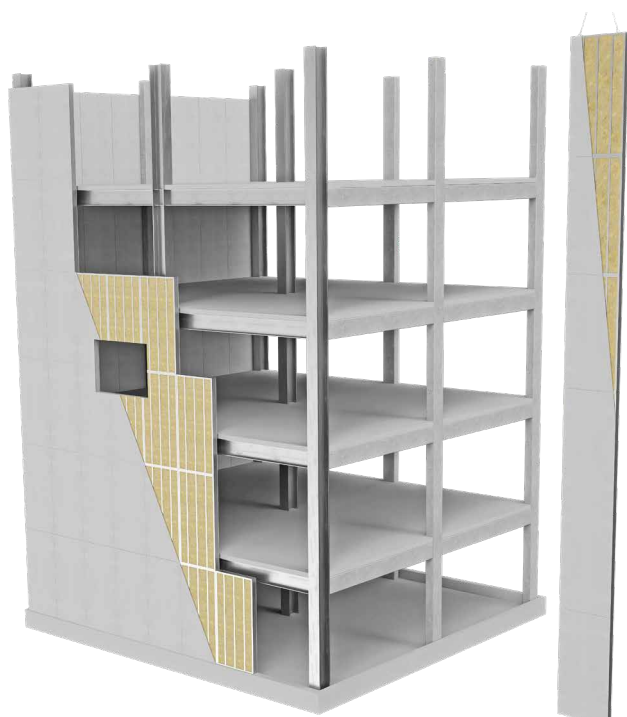

Maximum integrability of cold-formed profiles with plasterboard products makes it possible to build high-performance, energy-efficient enclosures.

Lightweight steel-framed panels make it possible to work smoothly on the facade and carry out energy upgrading and conversion of existing buildings.

When building façades, it is essential to protect the structure from water, rain, wind and sun (**TRASPIR EVO UV** membrane).

A careful fire design includes the integration of active or passive protective devices to prevent the spread of flames. Rothoblaas proposes the use of self-extinguishing membranes and tapes as a passive façade solution (flame retardant capacity B-s1,d0).

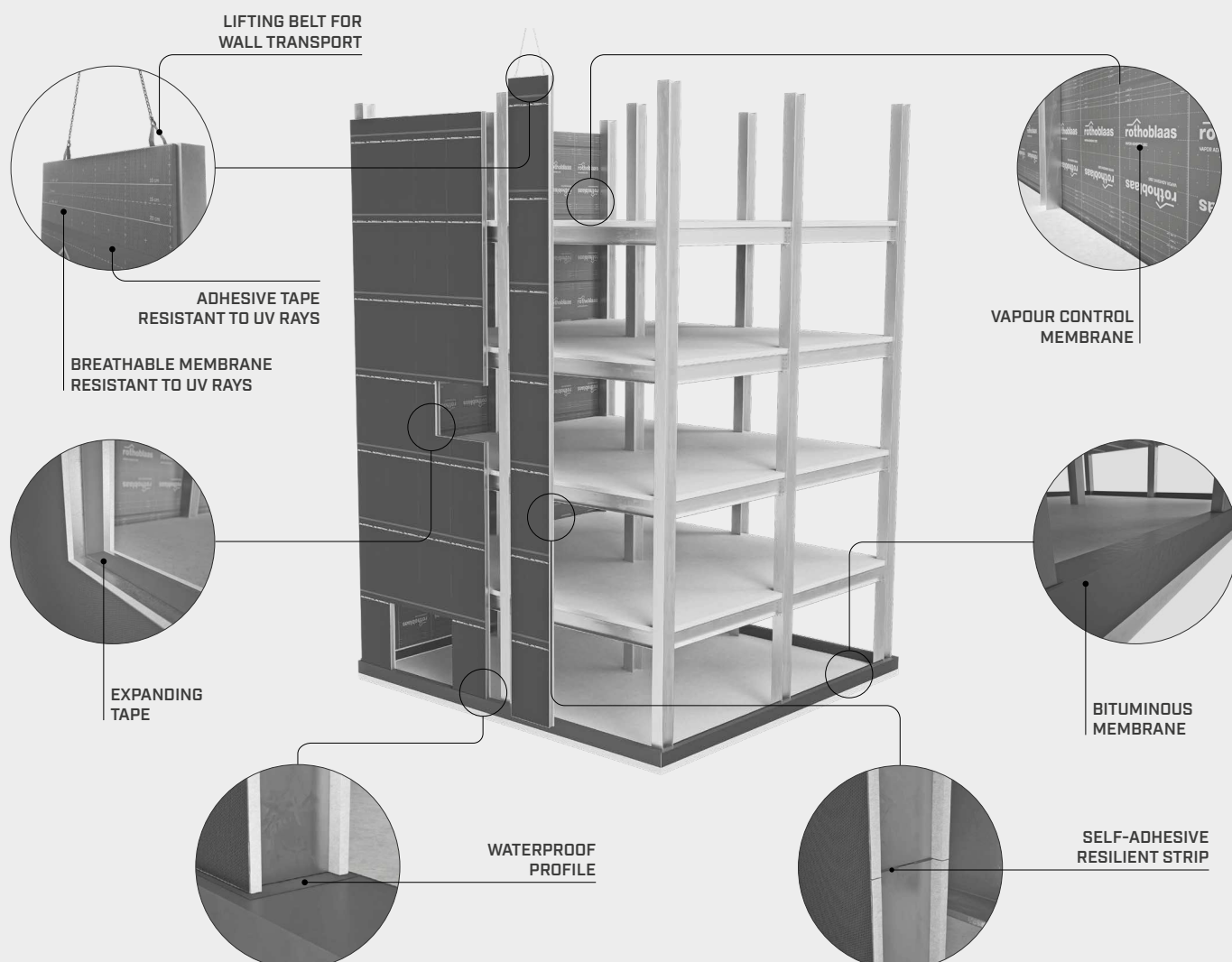

# FASTENING

## SCREWS AND ANCHORS

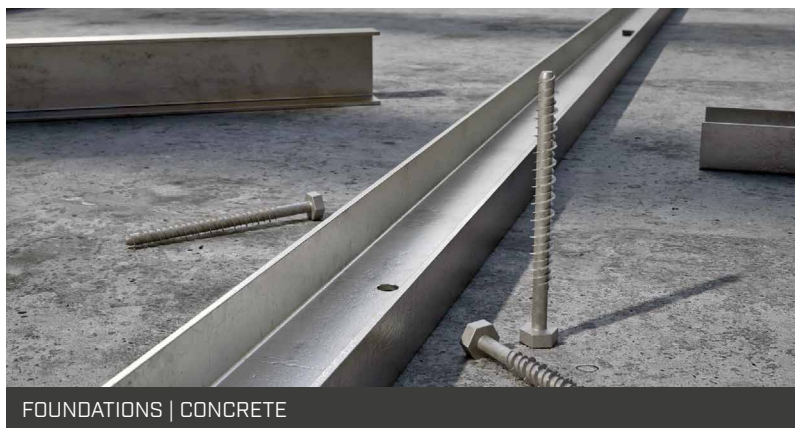

FOUNDATIONS | CONCRETE

### SKR

SCREW-IN ANCHOR FOR CONCRETE



### VIN - FIX

VINYL ESTER CHEMICAL ANCHOR WITHOUT STYRENE



### SBS - SBS A2 | AISI 304

SELF-DRILLING TIMBER-TO-METAL SCREW



### SBN - SBN A2 | AISI 304

SELF-DRILLING METAL SCREW

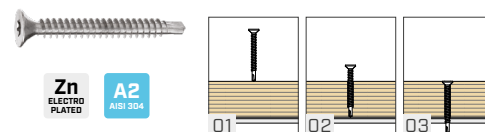

### DWS

DRYWALL SCREW

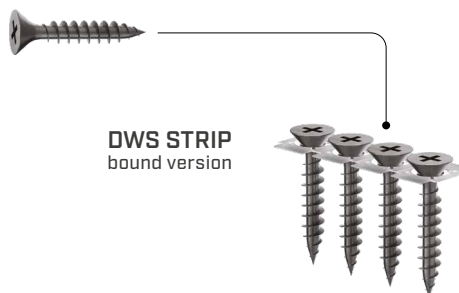

SELF-DRILLING SCREWS



PLASTERBOARD | GYPSUM FIBRE BOARDS

### ✓ RELATED PRODUCTS

#### SAR

SELF-DRILLING SCREW FOR STEEL, HEXAGONAL HEAD

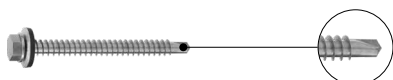

#### FAS A4 | AISI316

SCREWS FOR FAÇADES

A4  
AISI 316



#### NITRAN

NYLON-ELASTAN/NITRILE FOAM GLOVES



#### A 18 | ASB 18

CORDLESS SCREWDRIVER



#### THERMOWASHER

WASHER TO FASTEN INSULATION TO TIMBER



#### HEADPHONE

FOLDING EAR MUFFS





## FASTENING

# ANGLE BRACKETS AND PLATES

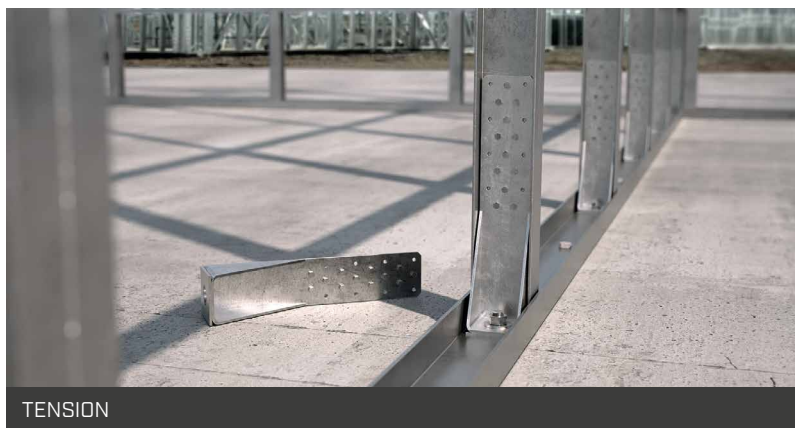

TENSION

### WHT

#### ANGLE BRACKET FOR TENSILE LOADS

The hold-down angle bracket suitable for any static or seismic requirement.



### WKR

#### TENSILE ANGLE BRACKET FOR BUILDINGS

Efficient solution in all applications that require normal values of tensile strength.



### WKF

#### ANGLE BRACKET FOR FACADES

Reinforcements are designed to ensure high levels of stiffness. Fast and easy installation.

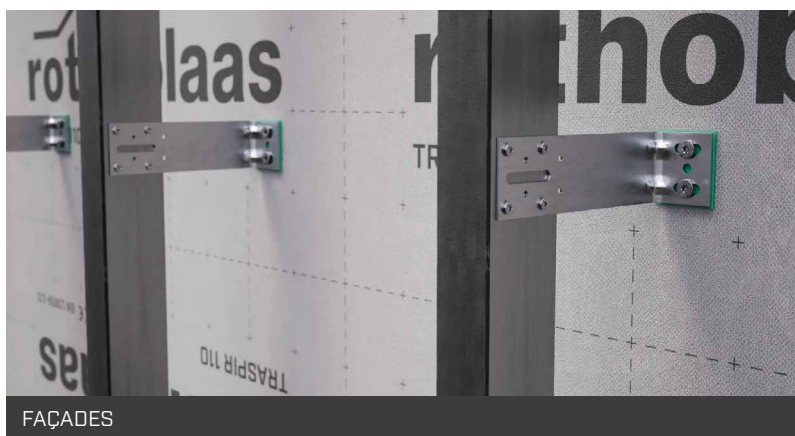

FAÇADES

### LBB + CLIPFIX

#### PERFORATED STRAP

Simple and effective to achieve floor bracing. It is available in thicknesses of 1,5 and 3,0 mm.

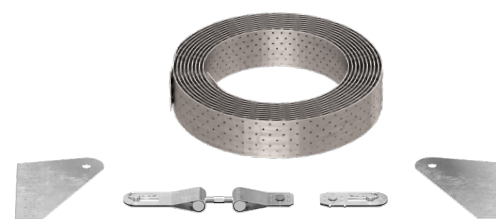

BRACINGS

## ✓ RELATED PRODUCTS

### NINO

UNIVERSAL ANGLE BRACKET FOR SHEAR AND TENSILE LOADS



### WHT PLATE C

PLATE FOR TENSILE LOADS



### TITAN PLATE T

PLATE FOR SHEAR LOADS



Discover the complete range of **FASTENING** on our website or request the catalogue from your trusted agent.  
[www.rothoblaas.com](http://www.rothoblaas.com)

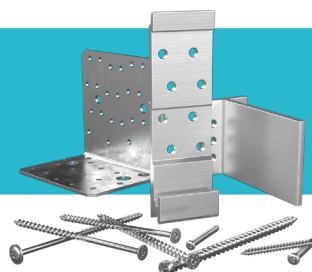

## WATER AND AIR TIGHTNESS TAPING

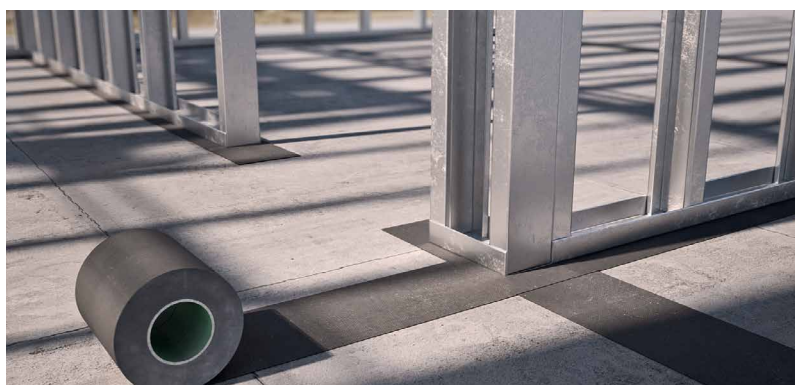

CONNECTION TO THE GROUND

### START BAND

WATERPROOF PROFILE WITH  
HIGH MECHANICAL RESISTANCE



### LEVEL BAND

DAMP-PROOF COURSE  
BARRIER FOR FOUNDATIONS



UNIVERSAL TAPES

### FLEXI BAND

UNIVERSAL SINGLE-SIDED  
HIGH-ADHESIVE TAPE

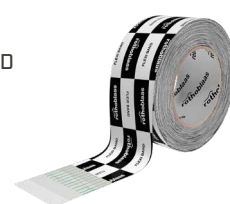

### SMART BAND

UNIVERSAL SINGLE-SIDED  
TAPE WITH SEPARABLE LINER



### EASY BAND

UNIVERSAL SINGLE-SIDED  
TAPE

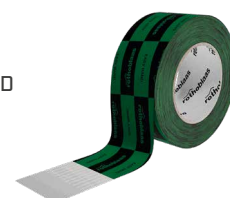

### PLASTER BAND IN/OUT

SPECIAL HIGH-ADHESION  
TAPE CAN BE PLASTERED



### FACADE BAND UV

UNIVERSAL SINGLE-SIDED  
TAPE, RESISTANT TO UV RAYS



### MULTI BAND

SPECIAL HIGH-ADHESION  
TAPE, CAN BE PLASTERED

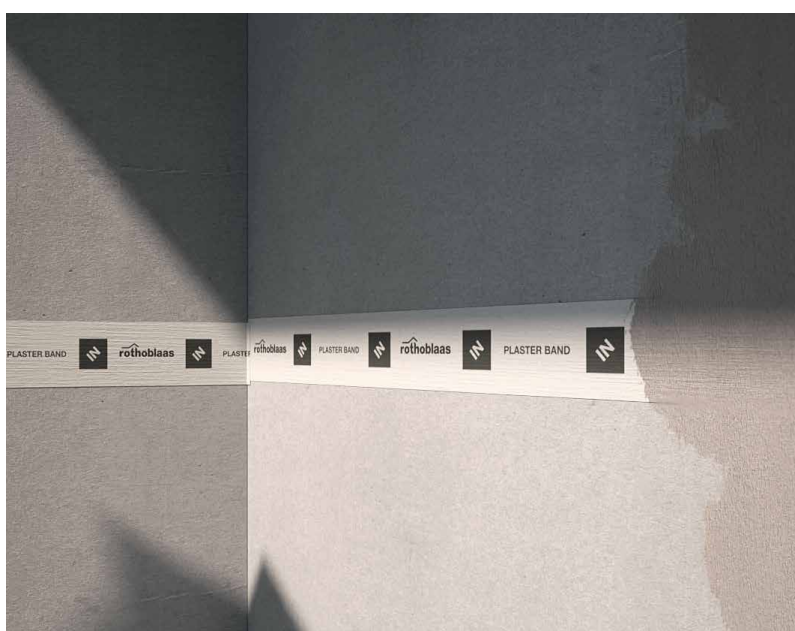

WALL TAPES

WATER AND AIR TIGHTNESS

## VAPOUR-RESISTANT BARRIERS AND MEMBRANES



### BARRIER NET SD40

VAPOUR BARRIER  
Sd 40 m



### BARRIER ALU NET SD150

REFLECTIVE VAPOUR  
BARRIER Sd 150 m



### VAPOR IN 120

VAPOUR CONTROL  
MEMBRANE



### CLIMA CONTROL 80

MEMBRANE WITH  
VARIABLE VAPOUR  
DIFFUSION



### CLIMA CONTROL 105

MEMBRANE WITH  
VARIABLE VAPOUR  
DIFFUSION



### VAPOR NET 110

VAPOUR CONTROL  
MEMBRANE WITH  
REINFORCEMENT  
GRID



WATER AND AIR TIGHTNESS

## HIGHLY BREATHABLE MEMBRANES

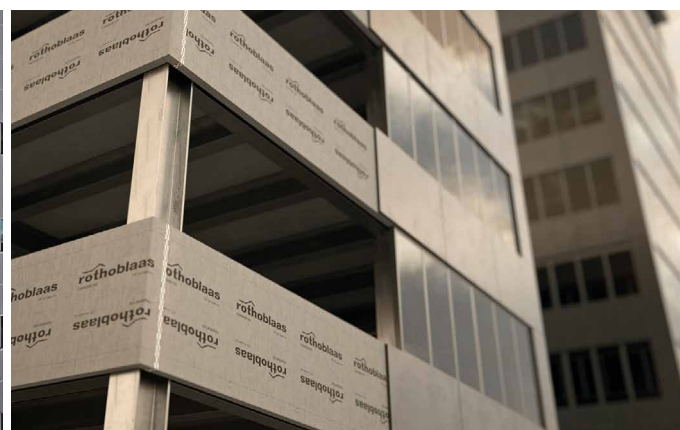
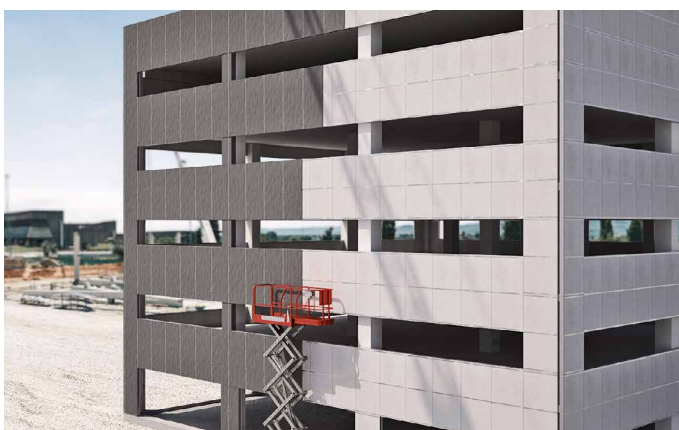

### TRASPIR EVO UV 115

BREATHABLE MONOLITHIC MEMBRANE  
RESISTANT TO UV RAYS



### TRASPIR EVO UV ADHESIVE

SELF-ADHESIVE BREATHABLE  
MONOLITHIC MEMBRANE RESISTANT TO  
UV RAYS



### TRASPIR 95

HIGHLY BREATHABLE  
MEMBRANE FOR WALLS



### TRASPIR EVO 135

MONOLITHIC BREATHABLE  
MEMBRANE





## WATER AND AIR TIGHTNESS GLUES AND SEALANTS

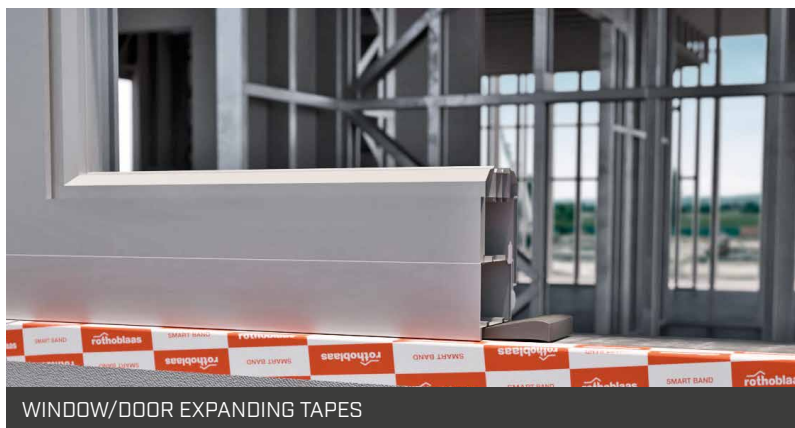

WINDOW/DOOR EXPANDING TAPES

### WINDOW BAND

SELF-EXPANDING  
SEALING TAPE FOR  
DOORS/WINDOWS



### EXPAND BAND

SELF-EXPANDING  
SEALING TAPE



### NAIL PLASTER

HIGH-ADHESION NAIL POINT  
SEALANT TAPE

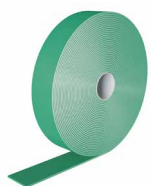

NAIL POINT GASKETS

### SMART FOAM

GENERAL PURPOSE  
FOAM SEALANT



### MEMBRANE GLUE

ADHESIVE GLUE  
FOR SEALING MEMBRANES



### FLUID MEMBRANE

SYNTHETIC SEALING  
MEMBRANE FOR BRUSH AND  
SPRAY APPLICATION



GLUES

The only element  
that protects you  
from the others.



Find out the  
TAPES, MEMBRANES,  
SEALANTS AND  
FIRE PROTECTION  
catalogue



**rothoblaas**

Solutions for Building Technology



## RECOMMENDATIONS FOR INSTALLATION

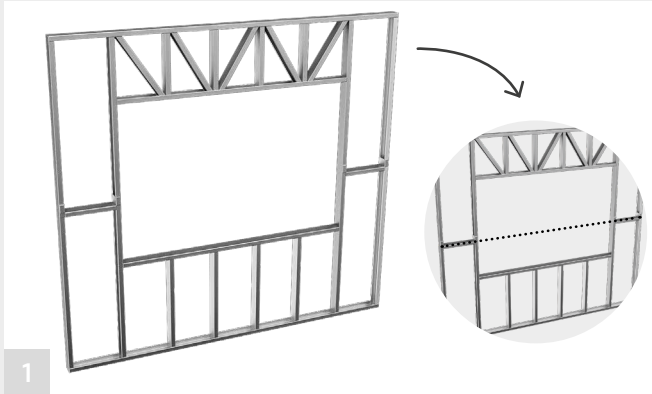

Once the structure is stable and ready for membrane installation, take the necessary measurements and mark where the upper edge of the lower membrane must be placed.

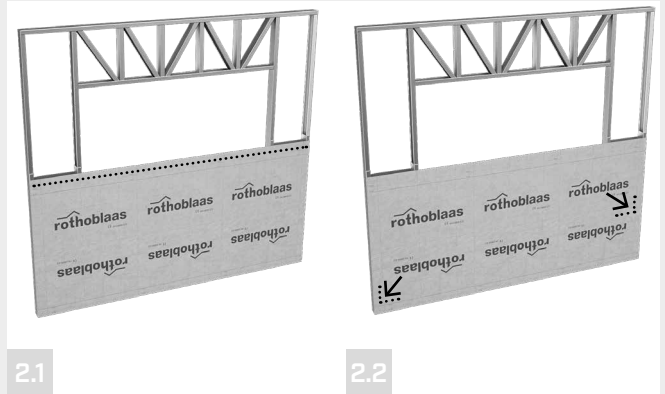

Place the lower membrane. 2.1 Seal the top area first with tape. 2.2 Then, pull and tension towards the lower centre point of the membrane. Finally, tension the lower outer corners of the membrane.

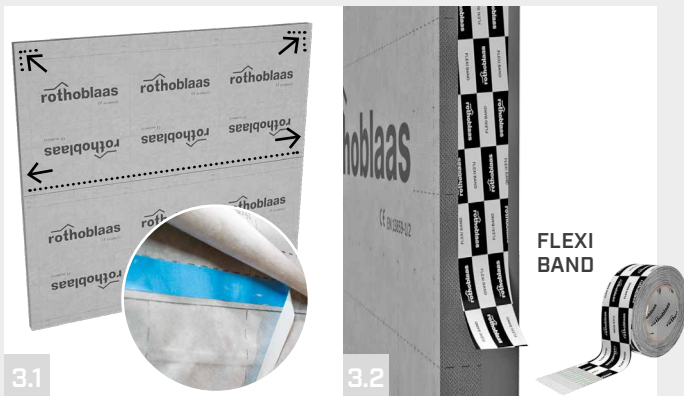

3.1 Mark the overlap at the top of the lower membrane. Then position the upper membrane, first joining it to the lower membrane with the tape. Pull the upper centre area, and then the upper outer corners. 3.2 Fasten the membrane to the profile with adhesive tape.

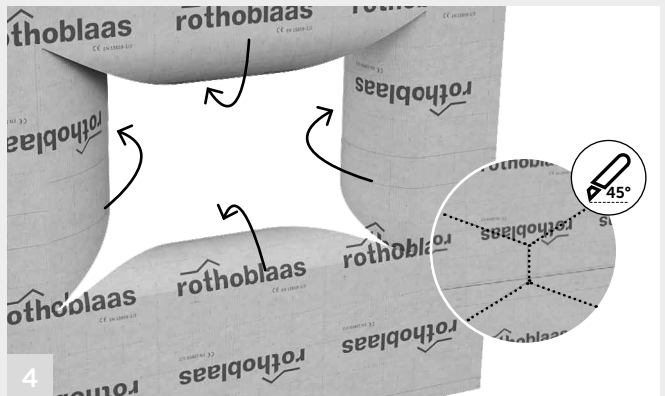

Cut the membrane in the window area, making an X-shaped cut up to, and not beyond, the window. Next, fold the membrane inwards securing it with tape and covering the window perimeter.

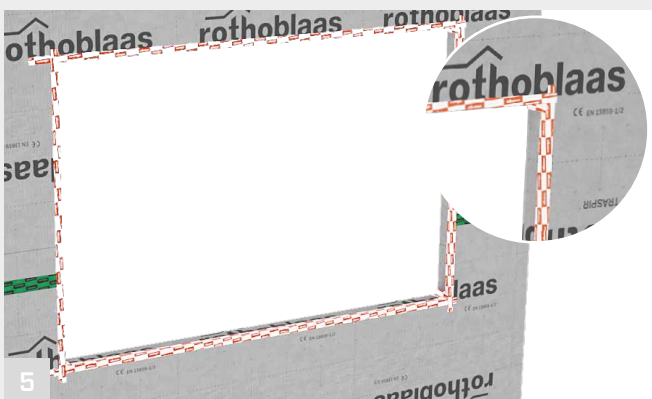

General view of the installation, including the window. Be careful to perfectly seal the interface between the membranes and any perforations created during installation, using a suitable tape for the conditions during assembly.

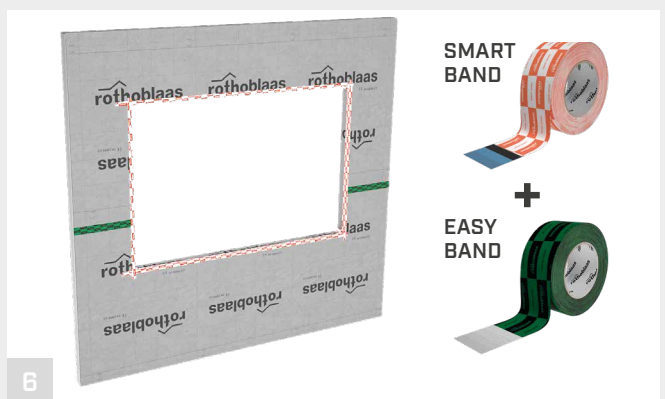

Tape and seal the corners of the window, taking care not to leave any gaps. At the bottom of the window, install a waterproof tape to seal the perforations created during window installation.



**SUBSCRIBE** to our **YOUTUBE** channel and stay updated on Rothoblaas products and news.  
Don't forget to activate the notifications!



## SOUNDPROOFING RESILIENT PROFILES

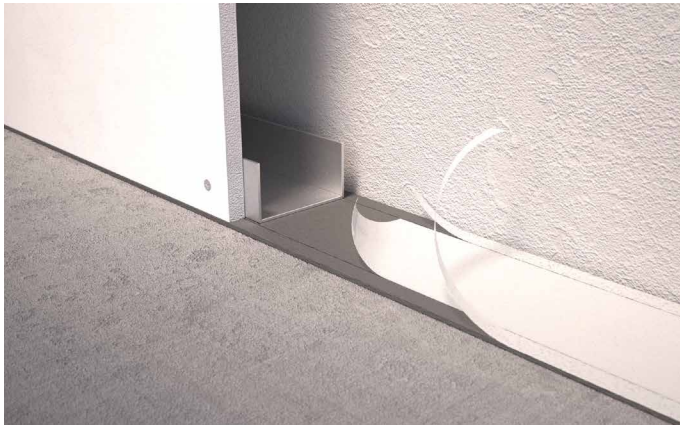

**SILENT GIPS**  
THERMAL-ACOUSTIC  
DECOUPLING TAPE  
FOR PLASTERBOARD  
STRUCTURES



**CONSTRUCTION SEALING**  
COMPRESSIBLE SEALING  
GASKET FOR REGULAR  
JOINTS



**SILENT UNDERFLOOR**  
RESILIENT STRIP  
FOR FLOOR  
UNDERBATTENS  
AND SUPPORTING WALLS



**XYLOFON**  
HIGH PERFORMANCE  
RESILIENT  
SOUNDPROOFING  
PROFILE



**ALADIN**  
RESILIENT  
SOUNDPROOFING  
PROFILE



**PIANO**  
RESILIENT  
SOUNDPROOFING  
PROFILE



## SOUNDPROOFING SOUNDPROOFING FOILS



**SILENT WALL BYTUM**  
SOUNDPROOFING AND WATERPROOFING  
BITUMINOUS MEMBRANE



**TRASPIR METAL**  
3D MATS FOR METAL ROOFS



**SILENT FLOOR TEX**  
UNDERSCREED MEMBRANE MADE OF  
RECYCLED TEXTILE FIBRE  
AND BARRIER

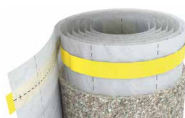

**SILENT FLOOR PE**  
RESILIENT UNDERSCREED  
MEMBRANE MADE OF CLOSED CELL PE





# FALL PROTECTION PPE AND COLLECTIVE PROTECTION

## POP

HELMET FOR  
WORKPLACE SAFETY,  
ON INDUSTRY AND  
CONSTRUCTION



## IRIS

HARNESS FOR  
FALL PROTECTION  
SYSTEMS



## FAST LINK

FAST LINKS



## WING

ANCHOR POINT FOR  
WORK AT HEIGHT AND  
IN SUSPENSION



## LINOSTOP

GUIDED TYPE FALL  
ARRESTER  
WITH FLEXIBLE  
ANCHOR LINE



## VERTICAL NET

VERTICAL POLYPROPYLENE FALL  
PROTECTION SAFETY NET

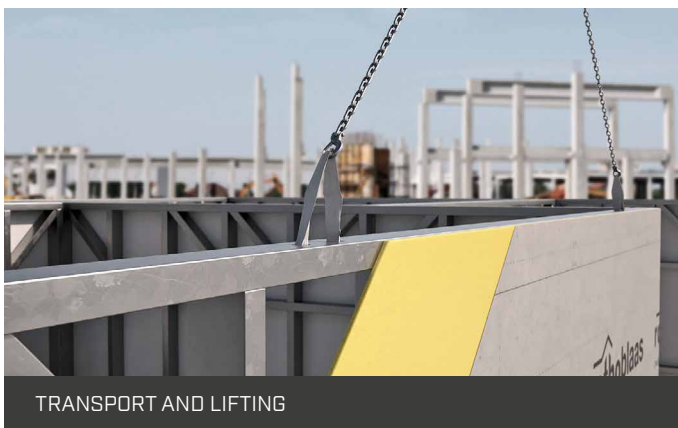
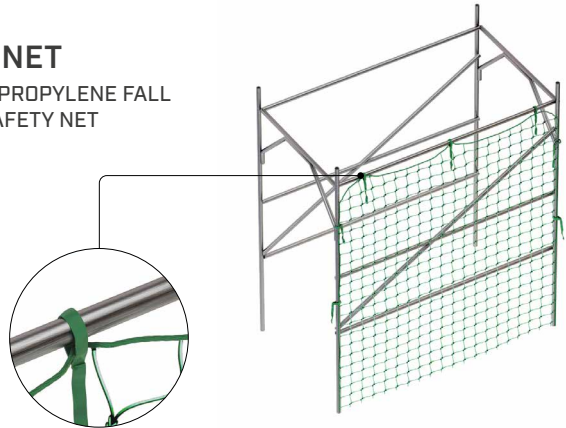

TRANSPORT AND LIFTING

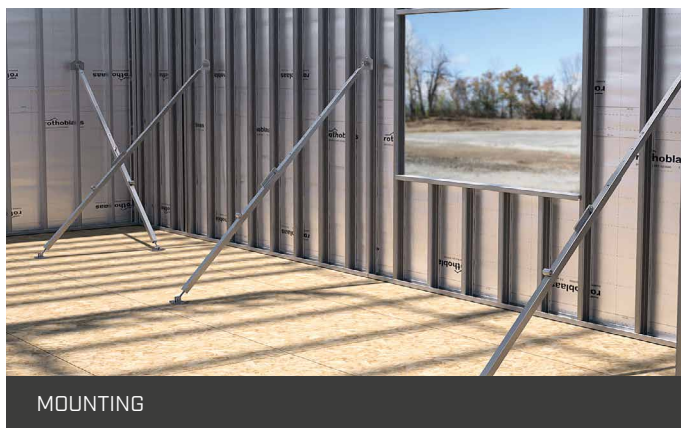

MOUNTING

## MANTIS

REUSABLE LIFTING BELT  
FOR TRANSPORT WALLS AND  
PRECAST ELEMENTS



## GIRAFFE

ASSEMBLY SUPPORT



**TOOLS AND MACHINES**, everything you need to work in best conditions on site. Discover them on our website or ask your trusted agent for the catalogue. [www.rothoblaas.com](http://www.rothoblaas.com)



- FASTENING
- AIRTIGHTNESS AND WATERPROOF
- SOUNDPROOFING
- FALL PROTECTION
- TOOLS AND MACHINES

## rothoschool



### TRAINING COURSES FOR OPERATORS AND DESIGNERS

Through partnerships with universities, research centres and specialized companies around the world, the training activities organized by Rothoblaas technicians involve experts with proven experience and expertise.

Whether you are a carpenter or a designer, having an interest in structural aspects of the envelope or in safety, you will find the course that is right for you.



Choose the course according to your needs  
[www.rothoblaas.com/school](http://www.rothoblaas.com/school)



#### Rotho Blaas Srl

Via dell'Adige N.2/1 | 39040, Cortaccia (BZ) | Italia  
 Tel: +39 0471 81 84 00 | Fax: +39 0471 81 84 84  
[info@rothoblaas.com](mailto:info@rothoblaas.com) | [www.rothoblaas.com](http://www.rothoblaas.com)

